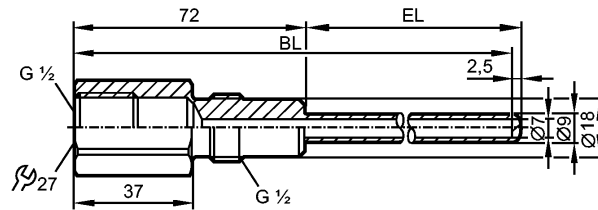

E37521

THERMOWELL, D6/ G1/2 conical/L=150

Accessories

EC 1935/2004 EHEDG Certified FDA
Product characteristics

Thermowell for temperature sensors

Ø 6 mm

Environment

Pressure rating [bar] 16

Mechanical data

Process connection	G 1/2
for units with process connection	G 1/2 with sealing cone
Installation length EL [mm]	118
Bore Length BL [mm]	187
Design	for temperature sensors with installation length EL = 150 mm
Housing materials	stainless steel 316L / 1.4404
Surface characteristics Ra / Rz of the wetted part(s)	≤ 0.6 / -
Weight [kg]	0.197

Remarks

Pack quantity [piece] 1