

## Datasheet

Daylight-visible, general-purpose indicators for indoor or outdoor use

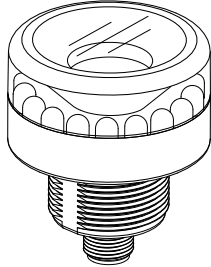

- Intense levels of light output for areas with high ambient light - even outdoors
- Viewable around entire perimeter; some models also emit light from top
- 1- or 2-color models available
- Rugged, sealed thermoplastic housing rated for IP67 and IP69K
- Bright, even light
- 12 to 30 V dc or 85 to 130 V ac (75 to 120 V dc) or 100 to 250 V ac (90 to 240 V dc) operation, depending on model
- 12V dc operation useful for applications on mobile vehicles
- Consult factory for models with strobing capability

## Models

Model		Connection <sup>1</sup>	LED Color(s)	Input Voltage
Perimeter View Only	Perimeter + Top View			
K50BLXGXPO	K50BCLXGXPO	4-pin Euro integral QD connector	Green	12 to 30 V dc
K50BLRXPO	K50BCLRXPO		Red	
K50BLXYPO	K50BCLXYPO		Yellow	
K50BLXBPO	K50BCLXBPO		Blue	
K50BLXWPO	K50BCLXWPO		White	
K50BLGRPO	K50BCLGRPO		Green / Red	
K50BLGA120Q	K50BCLGA120Q	3-pin Micro integral QD connector	Green	85 to 130 V ac or 75 to 120 V dc
K50BLRA120Q	K50BCLRA120Q		Red	
K50BLYA120Q	K50BCLYA120Q		Yellow	
K50BLWA120Q	N.A.		White	
K50BLBA120Q	K50BCLBA120Q		Blue	
K50BLGA230Q	K50BCLGA230Q		Green	
K50BLRA230Q	K50BCLRA230Q	Red		
K50BLYA230Q	K50BCLYA230Q	Yellow		
K50BLBA230Q	K50BCLBA230Q	Blue		

<sup>1</sup> Integral QD models only are listed.

- For 150 mm PVC pigtail with QD, replace Q with QP in model number (example, K50BLXGXQP).
- For 2 m (6.5') cable, omit suffix Q from model number (example, K50BLXGXP).
- A model with a QD requires a mating cable (see [Accessory Cordsets](#)).



## Specifications

### Supply Voltage and Current - 12-30 V dc models

K50BL 1-color models: 140 mA max. at 12 V dc, 70 mA max. at 30 V dc

K50BCL 1-color models: 160 mA max. at 12 V dc, 80 mA max. at 30 V dc

K50BL 2-color models, per color: 75 mA max. at 12 V dc, 40 mA max. at 30 V dc

K50BCL 2-color models, per color: 95 mA max. at 12 V dc, 40 mA max. at 30 V dc

### Supply Voltage and Current - 120 V ac models

K50BL models: 85 to 130 V ac or 75 to 120 V dc at 16 mA max. 50/60 Hz

K50BCL models: 85 to 130 V ac or 75 to 120 V dc at 60 mA max. 50/60 Hz

### Supply Voltage and Current - 230 V ac models

K50BL models: 100 to 250 V ac or 90 to 240 V dc at 20 mA max. 50/60 Hz

K50BCL models: 100 to 250 V ac or 90 to 240 V dc at 25 mA max. 50/60 Hz

### Supply Protection Circuitry

Protected against reverse polarity and transient voltages

### Indicators

LED colors are independently selected, depending on model

### Environmental Rating

Rated IEC IP67 and IP69K, per DIN 40050

### Construction

Base and covers: polycarbonate

### Connections

Integral 4-pin M12/Euro-style (dc models) QD, 3-pin Micro-style (ac models) QD, or 2 m (6.5 ft) integral cable, depending on model

### Operating Conditions

-40 °C to +50 °C (-40 °F to +122 °F)

90% at +50 °C maximum relative humidity (non-condensing)

### Vibration and Mechanical Shock

All models meet Mil. Std. 202F requirements method 201A (vibration: 10 to 60 Hz max., double amplitude 0.06 in, maximum acceleration 10G). Also meets IEC 947-5-2; 30G 11 ms duration, half sine wave.

### Indicator Power-up Response Time

DC models

ON: 10 ms; OFF: 7 ms

AC models

ON/OFF: 500 µs

### Application Note

Light emits 360° from housing sides in K50BL models and housing sides and tops in K50BCL models.

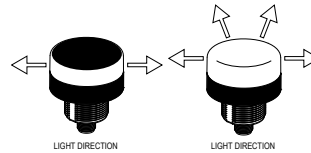

### Certifications



(dc models only)

## Dimensions

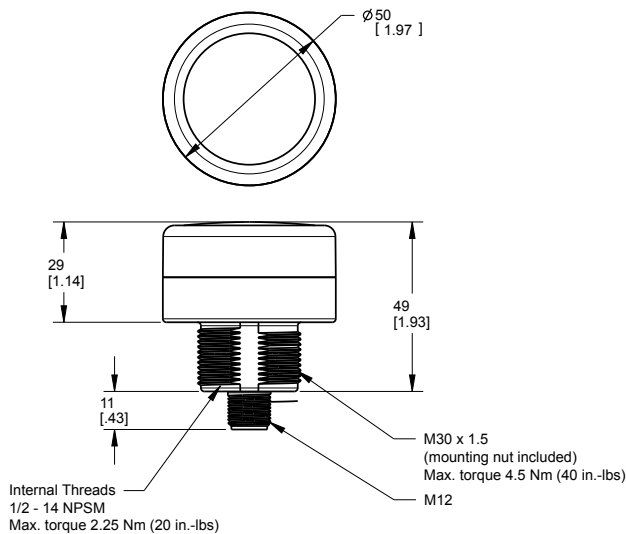

## Wiring – DC Models

1-Color Models (PNP/NPN Selectable)			
Sourcing (PNP) Input	Sinking (NPN) Input	Pinout	Wiring Key:
			1 = Brown 2 = White 3 = Blue 4 = Black C = Indicator color X = Not used

2-Color Models			
Sourcing (PNP) Input	Pinout	Wiring Key:	
		1 = Brown 2 = White 3 = Blue 4 = Black C1 = Indicator color 1 C2 = Indicator color 2 X = Not used	

## Wiring – AC Models

Quick-Disconnect (QD) Models	Cabled Models
<p><b>Wiring Key:</b>                      1 = Green (not used)                      2 = Red/Black                      3 = Red/White</p>	<p><b>Wiring Key:</b>                      1 = Black                      3 = White</p>
<p>Pinout</p>	

## Accessory Cordsets

4-Pin Threaded M12/Euro-Style Cordsets				
Model	Length	Style	Dimensions	Pinout (Female)
MQDC-406	1.83 m (6 ft)	Straight		
MQDC-415	4.57 m (15 ft)			
MQDC-430	9.14 m (30 ft)			
MQDC-450	15.2 m (50 ft)			

4-Pin Threaded M12/Euro-Style Cordsets				
Model	Length	Style	Dimensions	Pinout (Female)
MQDC-406RA	1.83 m (6 ft)	Right-Angle		
MQDC-415RA	4.57 m (15 ft)			
MQDC-430RA	9.14 m (30 ft)			
MQDC-450RA	15.2 m (50 ft)			

3-Pin Micro-Style Cordsets				
Model	Length	Style	Dimensions	Pinout (Female)
MQDC-306	1.83 m (6 ft)	Straight		<p>1 = Green 2 = Red/Black 3 = Red/White</p>
MQDC-315	4.57 m (15 ft)			
MQDC-330	9.14 m (30 ft)			
MQDC-306RA	1.83 m (6 ft)	Right-Angle		
MQDC-315RA	4.57 m (15 ft)			
MQDC-330RA	9.14 m (30 ft)			

## Accessory Mounting Brackets

All measurements are in mm

### SMB30A

- Right-angle bracket with curved slot for versatile orientation
- Clearance for M6 (¼ in) hardware
- Mounting hole for 30 mm sensor
- 12-ga. stainless steel

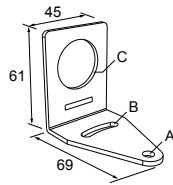

Hole center spacing: A to B=40  
Hole size: A=ø 6.3, B= 27.1 x 6.3, C=ø 30.5

### SMB30FA

- Swivel bracket with tilt and pan movement for precise adjustment
- Mounting hole for 30 mm sensor
- 12-ga. 304 stainless steel
- Easy sensor mounting to extrude rail T-slot
- Metric and inch size bolt available

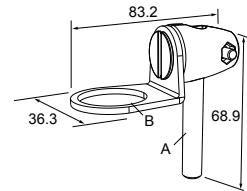

Bolt thread: SMB30FA, A= 3/8 - 16 x 2 in; SMB30FAM10, A= M10 - 1.5 x 50  
Hole size: B= ø 30.1

### SMB30MM

- 12-ga. stainless steel bracket with curved mounting slots for versatile orientation
- Clearance for M6 (¼ in) hardware
- Mounting hole for 30 mm sensor

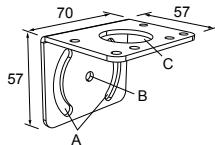

Hole center spacing: A = 51, A to B = 25.4  
Hole size: A = 42.6 x 7, B = ø 6.4, C = ø 30.1

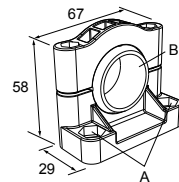

### SMB30SC

- Swivel bracket with 30 mm mounting hole for sensor
- Black reinforced thermoplastic polyester
- Stainless steel mounting and swivel locking hardware included

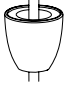

Hole center spacing: A=ø 50.8  
Hole size: A=ø 7.0, B=ø 30.0

## Elevated Mount System

Model			Features	Components
SA-M30E12 - Black Acetal			<ul style="list-style-type: none"> <li>Streamlined black acetal stand-off pipe adapter/cover</li> <li>Connects between 30 mm light base and ½ in. NPSM/DN15 pipe</li> <li>Mounting hardware included</li> </ul>	
Polished 304 Stainless Steel	Black Anodized Aluminum	Clear Anodized Aluminum	<ul style="list-style-type: none"> <li>Elevated-use stand-off pipe (½ in. NPSM/DN15)</li> <li>Polished 304 stainless steel, black anodized aluminum, or clear anodized aluminum surface</li> <li>½ in. NPT thread at both ends</li> <li>Compatible with most industrial environments</li> </ul>	
SOP-E12-150SS 150 mm (6 in) long	SOP-E12-150A 150 mm (6 in) long	SOP-E12-150AC 150 mm (6 in) long		
SOP-E12-300SS 300 mm (12 in) long	SOP-E12-300A 300 mm (12 in) long	SOP-E12-300AC 300 mm (12 in) long		
SOP-E12-900SS 900 mm (36 in) long	SOP-E12-900A 900 mm (36 in) long	SOP-E12-900AC 900 mm (36 in) long		
SA-E12M30 - Black Acetal			<ul style="list-style-type: none"> <li>Streamlined black acetal mounting base adapter/cover</li> <li>Connects between ½ in. NPSM/DN15 pipe and 30 mm (1-3/16 in) drilled hole</li> <li>Mounting hardware included</li> </ul>	

## Banner Engineering Corp Limited Warranty

Banner Engineering Corp. warrants its products to be free from defects in material and workmanship for one year following the date of shipment. Banner Engineering Corp. will repair or replace, free of charge, any product of its manufacture which, at the time it is returned to the factory, is found to have been defective during the warranty period. This warranty does not cover damage or liability for misuse, abuse, or the improper application or installation of the Banner product.

THIS LIMITED WARRANTY IS EXCLUSIVE AND IN LIEU OF ALL OTHER WARRANTIES WHETHER EXPRESS OR IMPLIED (INCLUDING, WITHOUT LIMITATION, ANY WARRANTY OF MERCHANTABILITY OR FITNESS FOR A PARTICULAR PURPOSE), AND WHETHER ARISING UNDER COURSE OF PERFORMANCE, COURSE OF DEALING OR TRADE USAGE.

This Warranty is exclusive and limited to repair or, at the discretion of Banner Engineering Corp., replacement. IN NO EVENT SHALL BANNER ENGINEERING CORP. BE LIABLE TO BUYER OR ANY OTHER PERSON OR ENTITY FOR ANY EXTRA COSTS, EXPENSES, LOSSES, LOSS OF PROFITS, OR ANY INCIDENTAL, CONSEQUENTIAL OR SPECIAL DAMAGES RESULTING FROM ANY PRODUCT DEFECT OR FROM THE USE OR INABILITY TO USE THE PRODUCT, WHETHER ARISING IN CONTRACT OR WARRANTY, STATUTE, TORT, STRICT LIABILITY, NEGLIGENCE, OR OTHERWISE.

Banner Engineering Corp. reserves the right to change, modify or improve the design of the product without assuming any obligations or liabilities relating to any product previously manufactured by Banner Engineering Corp.