

24 70 14

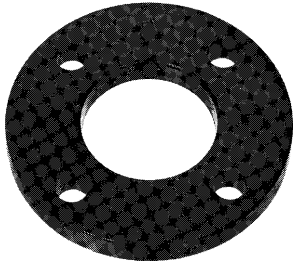

Backing Flanges for socket systems - all materials

Inch & Metric sizes

Material: Galvanised mild steel

Bolt circle diameter and bolt holes: B10:1962, table D & E

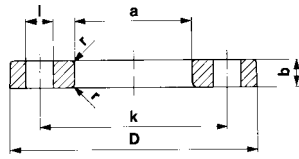

d mm	DN mm	Inch	PN	Code	£	SP	GP	g	D	a	k	b	l	r	AL	Bolts
20	15	1/2	16	724 701 406				220	96	28	67	7	15		4	M 12x 55
25	20	3/4	16	724 701 407				320	102	34	73	7	15		4	M 12x 60
32	25	1	16	724 701 408				410	115	42	83	7	15		4	M 12x 60
40	32	1 1/4	16	724 701 409				820	121	51	88	8	15		4	M 12x 70
50	40	1 1/2	16	724 701 410				1040	134	62	99	8	15		4	M 12x 75
63	50	2	16	724 701 411				1220	153	78	115	10	18		4	M 16x 80
75	65	2 1/2	16	724 701 412				1400	165	92	127	10	18		4	M 16x 85
90	80	3	16	724 701 413				1530	184	110	146	10	18		4	M 16x 90
110	100		16	724 703 414				1840	216	133	178	10	18		8	M 16x 95
		4D	16	724 701 414				1840	216	138	178	10	18		4	M 16x 95
		4E	16	724 701 415				1840	216	138	178	10	18		8	M 16x 95
125	125															
140	125	5	16	724 701 416				2070	254	167	210	10	18		8	M 16x110
160	150															
		6	16	724 701 417				2330	280	200	235	10	22		8	M 20x120
200	200															
225	200	8	10	724 701 419				2750	337	250	292	10	22		8	M 20x150

24 70 16

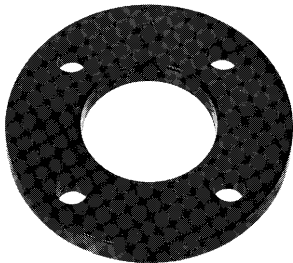

Backing Flanges for socket systems - all materials

Inch & Metric sizes

Material: Galvanised Mild Steel

Bolt circle diameter and bolt holes: ISO/BS4504: 1969 PN10/16

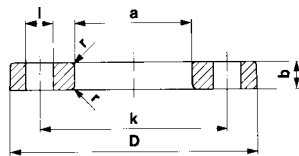

d mm	DN mm	Inch	PN	Code	£	SP	GP	g	D	a	k	b	l	r	AL	Bolts
20	15	1/2	16	724 701 606				220	95	28	65	7	14		4	M 12x 55
25	20	3/4	16	724 701 607				320	105	34	75	7	14		4	M 12x 60
32	25	1	16	724 701 608				410	115	42	85	7	14		4	M 12x 60
40	32	1 1/4	16	724 701 609				820	140	51	100	8	18		4	M 16x 70
50	40	1 1/2	16	724 701 610				1040	150	62	110	8	18		4	M 16x 75
63	50	2	16	724 701 611				1220	165	78	125	10	18		4	M 16x 80
75	65	2 1/2	16	724 701 612				1400	185	92	145	10	18		4	M 16x 85
90	80	3	16	724 701 613				1530	200	110	160	10	18		8	M 16x 90
110	100		16	724 700 014				1840	220	133	180	10	18		8	M 16x 95
		4	16	724 701 615				1840	220	133	180	10	18		8	M 16x 95
140	125	5	16	724 701 616				2070	250	167	210	10	18		8	M 16x110
160	150															
		6	16	724 701 617				2330	285	200	240	10	22		8	M 20x120
200	200															
225	200	8	10	724 701 620				1584	340	250	295	10	22		8	M 20x150
225	200	8	16	724 701 720				1584	340	250	295	10	22		12	M 20x150