

TS325A

TS-300KEKD06...../3M/3D/3G

Temperature sensors

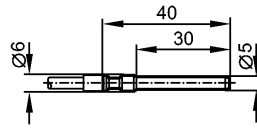

Product characteristics

Temperature sensor for connection to evaluation units

Ø 5 mm

Cable

ATEX approval

Group II, category 3D/3G

Measuring range: -20...80 °C / -4...176 °F, Measuring range for non-ATEX applications: -20...180 °C / -4...356 °F

Measuring element: 1 x Pt 100, to DIN EN 60751, class B, operating current max. 10 mA

Application

Application liquids and gases

Minimum installation depth [mm] 15

Electrical data

Protection class III

Measuring / setting range

Measuring range -20...80 °C -4...176 °F

Measuring range for non-ATEX applications -20...180 °C / -4...356 °F

Accuracy / deviations

Accuracy ± (0.30 K + 0.005 x |t|)

Reaction times

Dynamic response T05 / T09 [s] 4 / 10 *)

Environment

Ambient temperature [°C] -20...80

Protection IP 67

Tests / approvals

Marking of the unit Ex II 3D Ex tc IIIC T100°C Dc X
 Ex II 3G Ex nA IIC T5 Gc X

MTTF [Years] 19348

Mechanical data

Materials (wetted parts) stainless steel 316L / 1.4404

Probe diameter [mm] 5 / 6

Housing materials stainless steel 316L / 1.4404

Weight [kg] 0.088

Electrical connection

Connection silicone cable / 3 m

Wiring



TS325A

TS-300KEKD06...../3M/3D/3G

Temperature sensors

Core colors

WH white
BK black
RD red

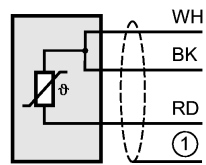

1 = screen (not connected to the housing)

Remarks

Remarks

*) according to DIN EN 60751
The values for accuracy apply to flowing water.

Pack quantity

[piece]

1