

## 2115 11

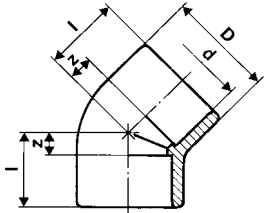

## Elbows 45°

d	PN	Code	£	SP	GP	g	z	D	l
3/8	15	721.151.105		5		12	4	23	20
1/2	15	721.151.106		10		15	7	28	24
3/4	15	721.151.107		10		26	8	33	29
1	15	721.151.108		10		45	10	41	33
1 1/4	15	721.151.109		10		80	11	51	40
1 1/2	15	721.151.110		10		135	11	57	41
2	15	721.151.111		10		257	15	72	51
2 1/2	15	721.150.112		1		421	18	95	62
3	15	721.151.113		10		570	21	105	72
4	15	721.151.115		10		1170	26	135	89
5	15	721.150.116		1		1630	32	164	108
6	15	721.151.117		2		2520	38	198	129
8*	9	721.151.120		1		5800	49	250	168

\* Maximum working pressure: 9 bar (130 lbf/in<sup>2</sup>) at 20°C.

## 2120 11

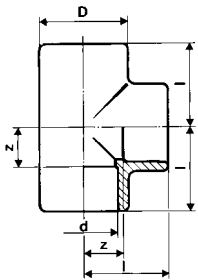
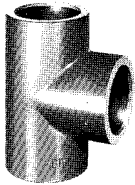

## Tee 90°

d	PN	Code	£	SP	GP	g	z	D	l
3/8	15	721.201.105		10		18	10	25	25
1/2	15	721.201.106		10		25	13	30	30
3/4	15	721.201.107		10		40	16	35	37
1	15	721.201.108		10		75	19	43	43
1 1/4	15	721.201.109		10		110	22	53	51
1 1/2	15	721.201.110		5		200	26	60	56
2	15	721.201.111		5		366	32	73	68
2 1/2	15	721.200.112		1		586	40	92	84
3	15	721.201.113		5		970	46	107	97
4	15	721.201.115		2		1640	59	138	122
5	15	721.200.116		1		3260	71	172	147
6	15	721.201.117		2		4790	86	202	176
8*	9	721.201.120		1		11600	114	256	233

\* Maximum working pressure: 9 bar (130 lbf/in<sup>2</sup>) at 20°C.

## 2125 11

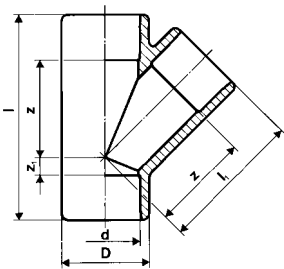
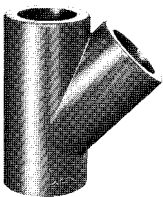

## Tee 45°

d	PN	Code	£	SP	GP	g	z	z <sub>1</sub>	D	l	l <sub>1</sub>
1/2	9	721.251.106		5		36	30	6	28	68	46
3/4	9	721.251.107		5		50	35	8	33	83	55
1	9	721.251.108		5		90	43	8	41	99	67
1 1/4	9	721.251.109		5		163	55	9	50	118	82
1 1/2	9	721.251.110		5		240	67	13	60	140	97
2	9	721.251.111		5		500	87	16	74	175	123
2 1/2	6	721.250.112		1		940	101	18	91	207	145
3	6	721.251.113		1		1246	122	20	107	245	173
4	6	721.251.115		1		2380	147	25	134	298	210

Maximum working pressure:  
 Sizes 1/2 - 2: 9 bar (130 lbf/in<sup>2</sup>) at 20°C. Sizes 2 1/2 - 4: 6 bar (87 lbf/in<sup>2</sup>) at 20°C