

2/2 or 3/2-way Solenoid Valve for aggressive media

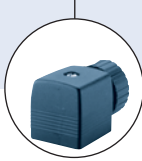

- Pivoted armature valve with manual override
- Direct-acting with separating diaphragm
- Different circuit function available
- Suitable for aggressive media
- Plastic PP or PVDF body

Type 0124 can be combined with...



Type 2508
Cable plug



Type 1078
Timer unit

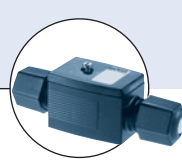

Type 2511
ASI cable plug

The Type 0124 is a direct-acting 2/2 or 3/2-way pivoted armature solenoid valve. Available in many circuit functions for opening, closing, dosing, mixing and distribution. The magnetic system and the media chamber are separated by a diaphragm system.

Circuit function A

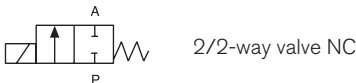

Circuit function C

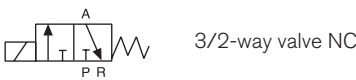

Circuit function E

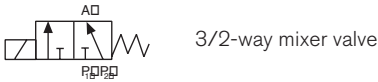

Circuit function F

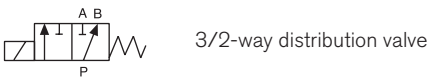

Technical data	
Orifice	DN 3.0 - 5.0
Body and seat material	PP, PVDF
Seal material	EPDM, FKM
Media	Alkalis, acids up to medium concentrations, alkaline washing and bleaching lyes, Oxidising acids and substances, oils, salt solutions, waste gases
EPDM	
FKM	
Media temperatur	
EPDM	-30 to +80 °C
FKM	0 to +80 °C
Ambient temperature	max. +55 °C
Voltage	± 10%
Duty cycle	Intermittent operation 40% (30 min) with 8 W version or 100% continuous rating with 5 W version (on request)
Electrical connection	Cable plug for Ø 7 mm (supplied as standard)
Protection class	IP 65 with cable plug
Installation	As required, preferably with actuator upright

Materials

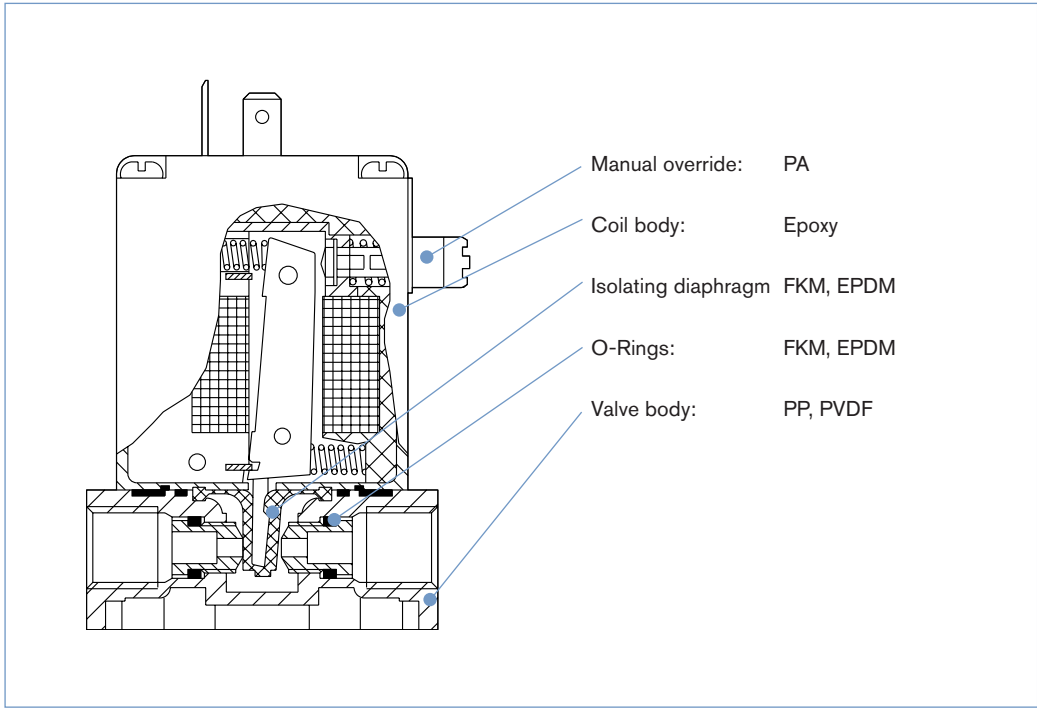

Technical data

Inrush		Hold		Weight kg
AC [VA]	DC [W]	AC [VA/W]	DC [W]	
30	8	15/8	8	0.4

The springs of each valve are set up for a specific circuit function. When using them in other circuit functions, the permissible operating pressure changes according to the following table.

Circuit function	Max. operating pressure [bar] when using the valve in a new circuit function											
	Orifice 3.0						Orifice 4.0					
	A	B	C	D	E	F	A	B	C	D	E	F
C	10	1	10	1	1	10	5	0.8	5	0.8	0.8	5
D	6	6	6	6	6	3	3	3	3	3	3	3
F	5	1	6	1	1	10	4	1	4	1	1	4

DTS 1000010905 EN Version: B Status: RL (released | freigegeben | validé) printed: 30.06.2006

Ordering chart for valves (other versions on request)

All valves body material PP, with manual override and cable plug, different seal materials

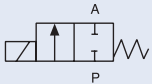
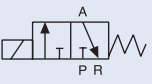
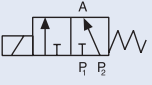
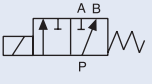
Circuit function	Orifice [mm]	Kv value water [m ³ /h]	Port connection	Pressure range [bar]	Voltage/frequency [V/Hz]	Item no. Seal material FKM	Item no. Seal material EPDM			
 <p>2/2-way valve NC</p>	3.0	0.25	G 1/4	0-8	024/DC	018 410	067 214			
				0-10	24/50	088 496	022 105			
					042/50	-	079 399			
					230/50	045 653	062 398			
				4.0	0.30	G 1/4	0-4	024/DC	062 695	021 660
							0-5	024/50	043 005	067 731
	110/50	087 029	-							
	230/50	063 116	063 118							
		5.0	0.40	G 1/4	0-3	024/DC	062 624	061 321		
					0-4,5	024/50	067 007	054 261		
	110/50					-	088 468			
	230/50	022 619	049 969							
4.0		0.30	G 1/4	0-5	024/50	088 420	-			
				230/50	-	063 625				
 <p>3/2-way valve NC</p>	3.0	0.25	G 1/4	0-4	024/DC	069 917	078 556			
				0-6	024/50	066 230	-			
					230/50	022 294	078 559			
					4.0	0.30	G 1/4	0-2	024/DC	061 077
				0-3	024/50			086 921	044 693	
					230/50			053 406	066 033	
 <p>3/2-way mixer valve</p>	4.0	0.30	G 1/4	0-4	024/DC	020 528	-			
				0-5	230/50	-	066 032			
 <p>3/2-way distribution valve</p>	4.0	0.30	G 1/4	0-4	024/DC	020 528	-			
				0-5	230/50	-	066 032			

All valves with body material PVDF, manual override and cable plug, seal material FKM (EPDM on request)

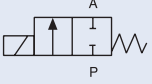
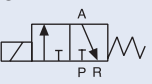
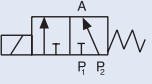
 <p>2/2-way valve NC</p>	3.0	0.25	G 1/4	0-8	024/DC	018 188			
				0-10	24/50	020 286			
					110/50	078 784			
					230/50	069 006			
				4.0	0.30	G 1/4	0-4	024/DC	023 472
							0-5	024/50	069 079
	230/50	087 837							
	5.0	0.40	G 1/4	0-3	024/DC	064 512			
				0-4,5	230/50	063 786			
					0-4	024/DC	055 788		
	 <p>3/2-way valve NC</p>	4.0	0.30	G 1/4	0-5	230/50	019 078		
					 <p>3/2-way mixer valve</p>	4.0	0.30	G 1/4	0-2
0-3	024/50	020 550							
	230/50	085 599							

DTS 1000010905 EN Version: B Status: RL (released | freigegeben | validé) printed: 30.06.2006

Dimensions

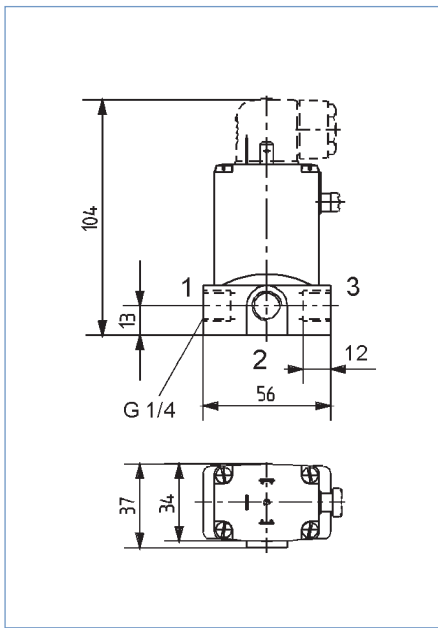

The ports are marked with 1, 2 and 3 as indicated in the configuration table, depending on the circuit function.

Possible port configurations

Circuit function	1	2	3
A ¹⁾	A	-	P
C	P	A	R
E	P1	A	P2
F	A	P	B

¹⁾ Type 0124 has no middle connection in circuit function A.

To find your nearest Bürkert facility, click on the orange box → www.burkert.com

In case of special application conditions, please consult for advice.

We reserve the right to make technical changes without notice.

0601/1_EU_en_00891602